

# Screen printing press

## STANDARD PARTS



### 1. DIN 912 Screws

- 1.1. M4x25mm (\*6)
- 1.2. M6x16mm (\*4)
- 1.3. M6x20mm (\*15)
- 1.4. M6x25mm (\*4)
- 1.5. M6x30mm (\*2)
- 1.6. M6x40mm (\*2)
- 1.7. M6x90mm (\*1)
- 1.8. M6x100mm (\*4)

### 2. Wooden Screws

- 2.1. 4,5x25mm (\*4)
- 2.2. 4,5x40mm (\*4)

### 3. Washers

- 3.1. M4x13mm (\*12)
- 3.2. M6x30mm (\*8)
- 3.3. M6x18mm (\*22)

### 4. Nuts

- 4.1. M4 (\*6)
- 4.2. M6 (\*3)
- 4.3. M8 (\*2)
- 4.4. Cap nut M6 (\*5)
- 4.5. Rectangular nut M6 (\*20)
- 4.6. Eye-nut M6 (\*4)

### 5. Aluminium profile

- 5.1. 30x60x160mm (\*1)
- 5.2. 30x60x590mm (\*1)

### 6. Bearing 6x19x6mm (\*2)

### 7. Angle bracket 28x28x28mm (\*6)

### 8. Foot 8x60x40mm (\*2)

### 9. Handle M8x12mm (\*2)

### 10. Spring 140mm (\*2)

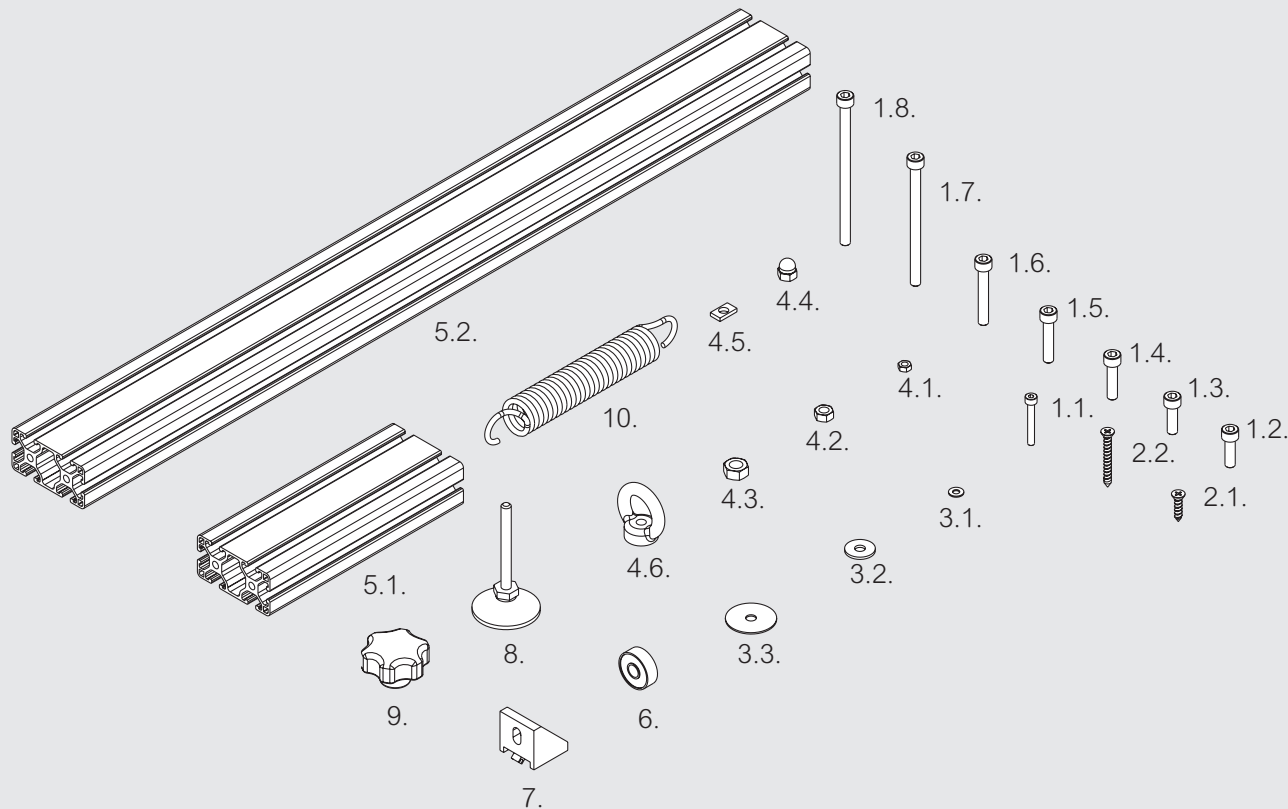

# Screen printing press

## SPECIFIC PARTS



1. STEP#01
2. STEP#06
3. STEP#08
4. STEP#09
5. STEP#13
6. STEP#14
7. STEP#15
8. STEP#19
9. STEP#20

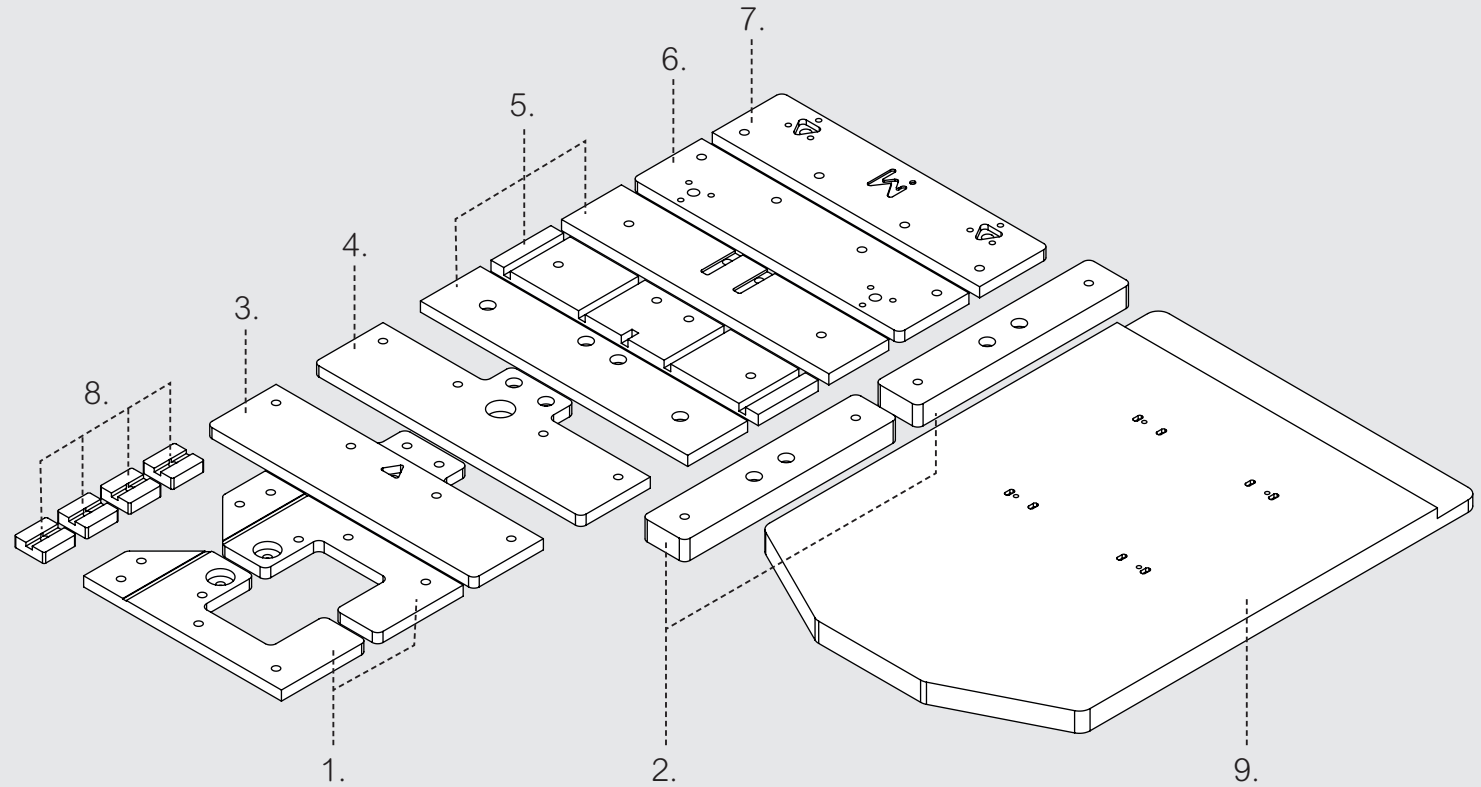

# Screen printing press

## TOOLS NEEDED



1. Hex key 3mm (INCLUDED)
2. Hex Key 5 mm (INCLUDED)
3. Multi Tool M4/M6/M8 (INCLUDED)
4. Measure tape or ruller (**NOT** INCLUDED)
5. Cross-head Screwdriver (**NOT** INCLUDED)

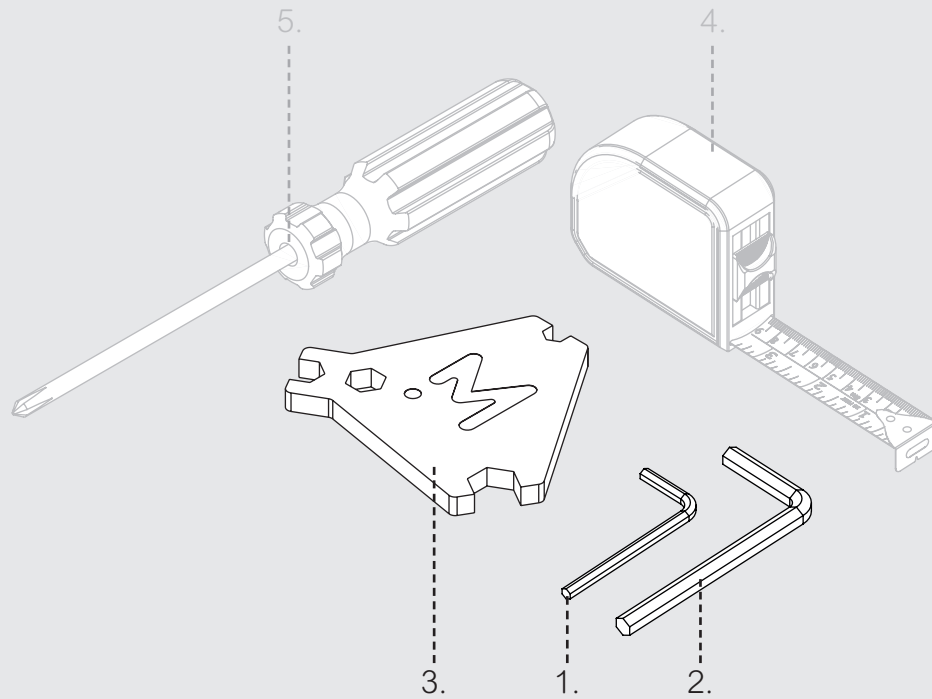

# Screen printing press BASE

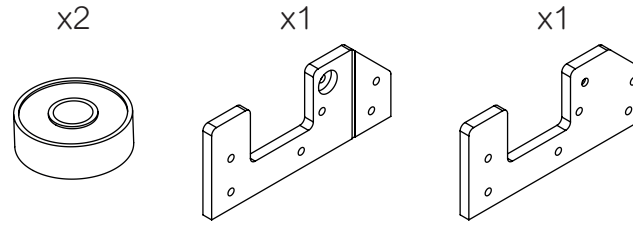

## STEP #01

1. Insert the two bearings inside the holes (it is supposed to be tight and hold in place)

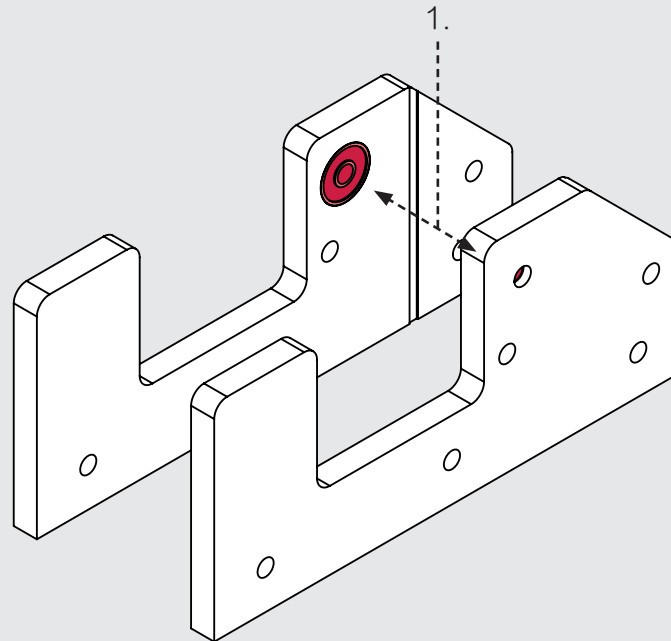

## Screen printing press BASE



5mm



x2

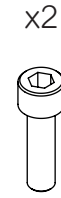

x2

M6x20



x2

M6x18



### STEP #02

1. Strongly tighten the screws, they will support the tension of the springs
2. Place the eye nuts with a 45° angle (it will help you with the springs later)

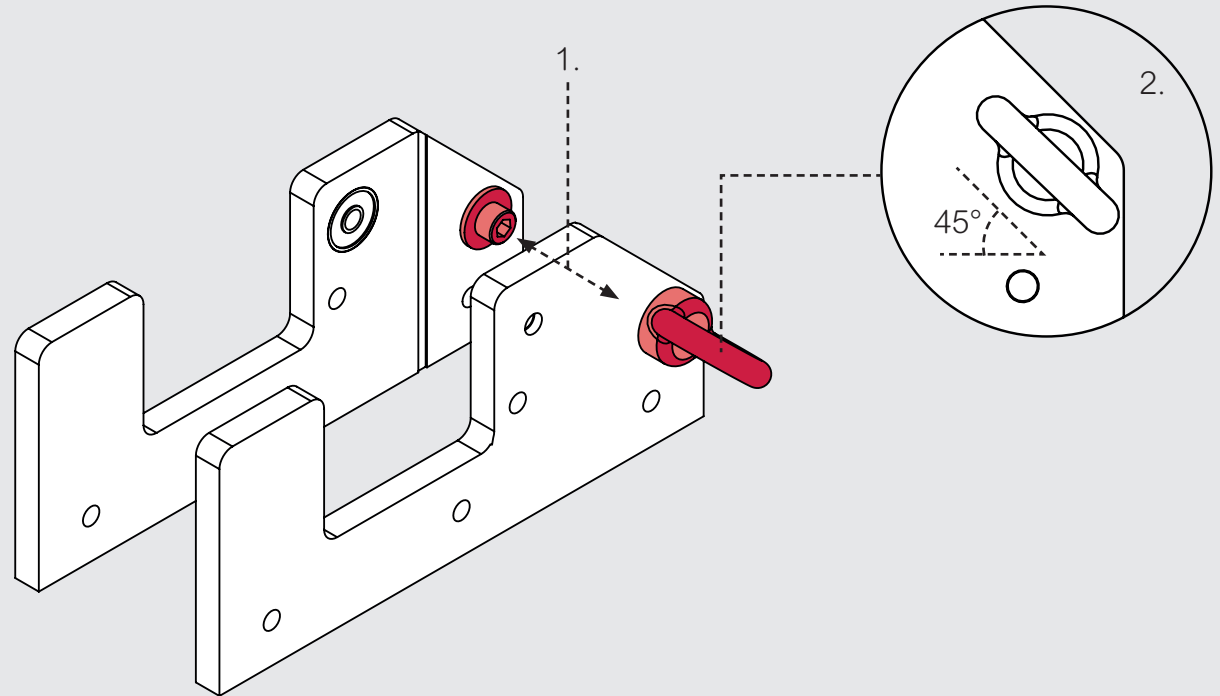

x6



M6x20

x6



M6x18

x6

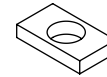

## STEP #03

1. Place the screws and washers inside their holes on both sides
2. Screw all the rectangular nuts but do not tighten them now (you will slide them into the aluminium rail during the next step)

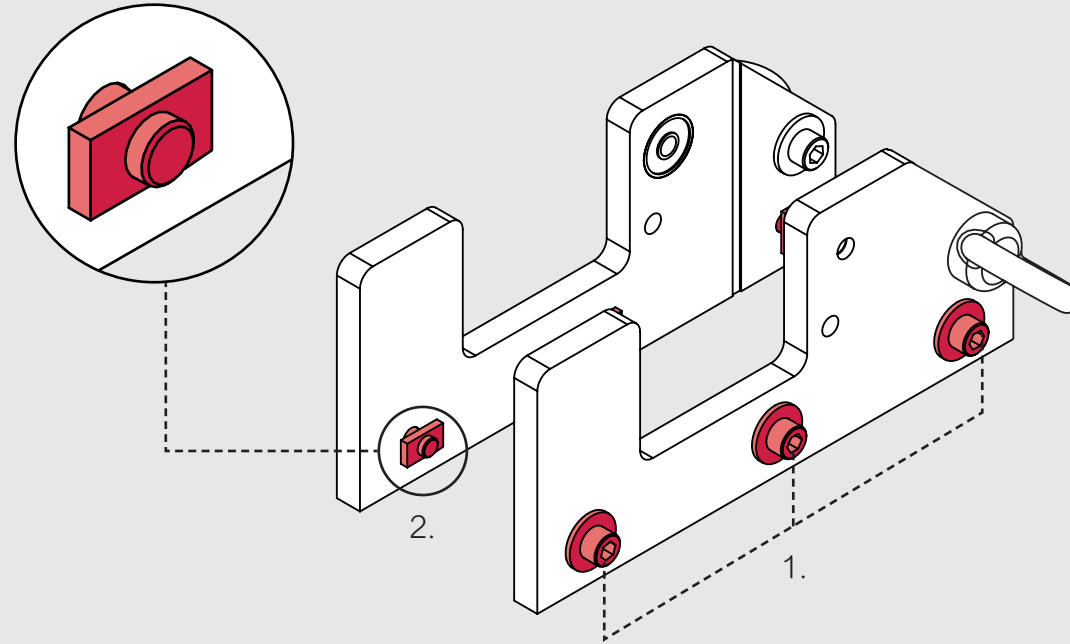

## Screen printing press BASE



5mm

x1

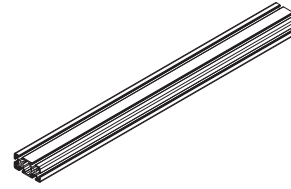

30x60x590

### STEP #04

1. Slide the aluminium rail and make sure all the rectangular nuts fit the aluminium slot
2. Do not fully tighten the screws now (STEP#22)

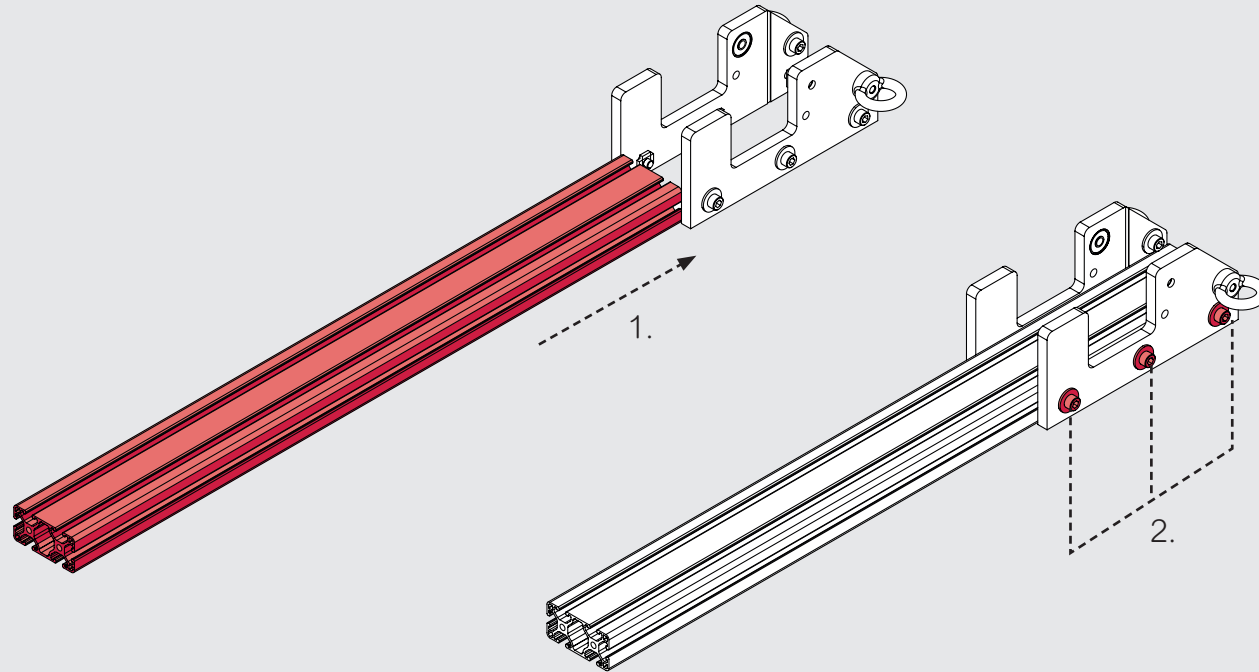



## Screen printing press BASE

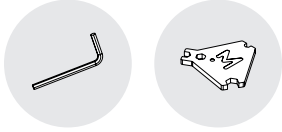

5mm

x1



M6x90



x4

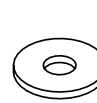

M6x18

x1



## STEP #05

1. Place the M6x90 screw and use two washers on each side
2. Screw the cap nut

\*Use the 5mm Hex key to tight the screw and the multi tool to hold the cap nut

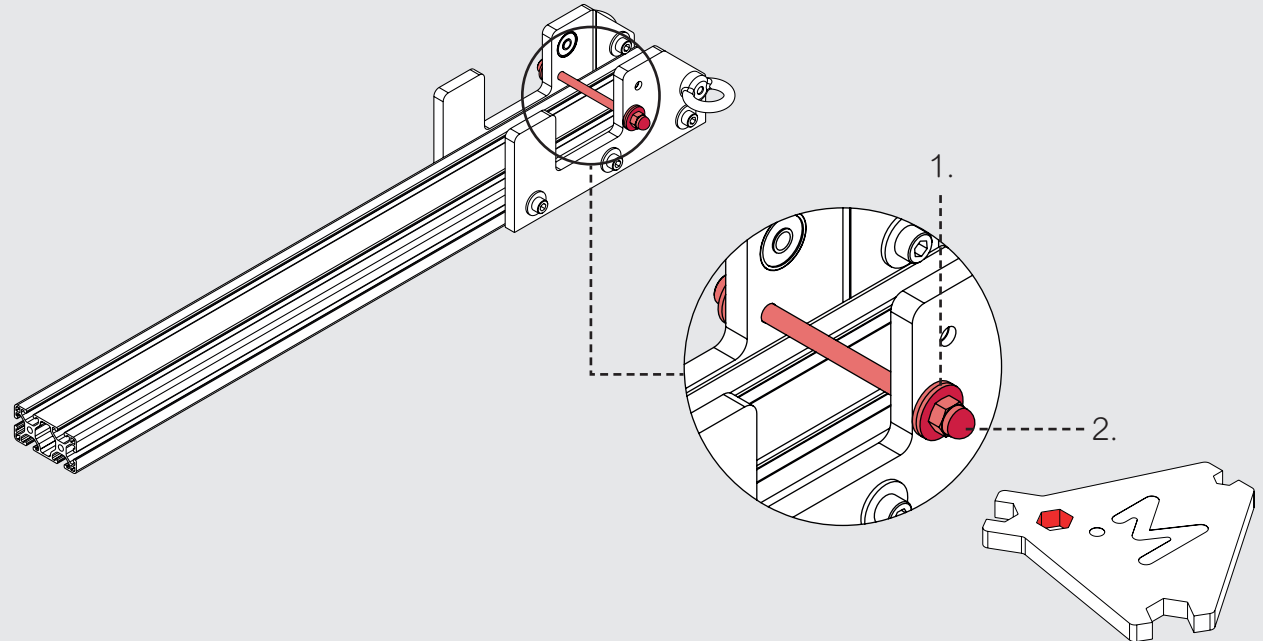

# Screen printing press BASE



x4



x4

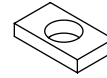

x2

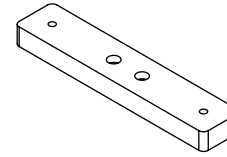

M6x20



## STEP #06

1. Place the screws in the holes
2. Screw all the rectangular nuts but do not tight them (you will slide them)

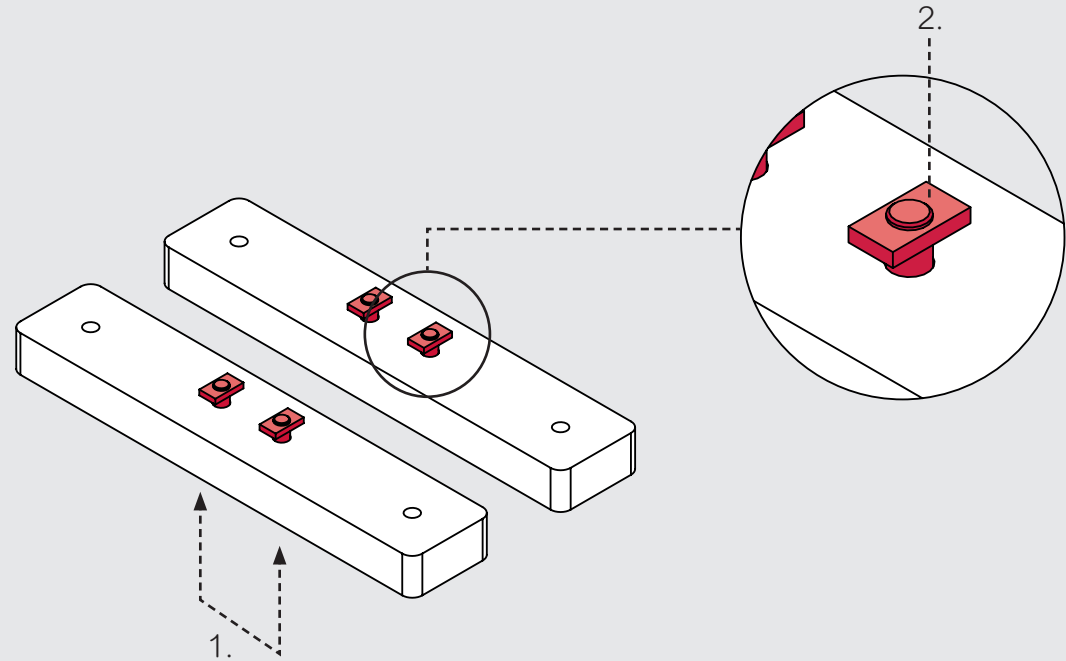

## Screen printing press BASE



5mm

STEP #05

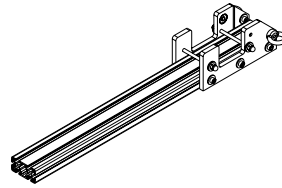

STEP #06

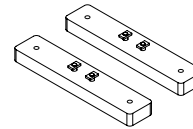

## STEP #07

1. Slide the parts in the aluminium rail and make sure all the rectangular nuts fit the aluminium slot
2. Tighten the screws when both the specific part are aligned like shown on the sketch
3. Tighten the screws when the side of the specific part is approximately 20cm from the edge of the aluminium rail

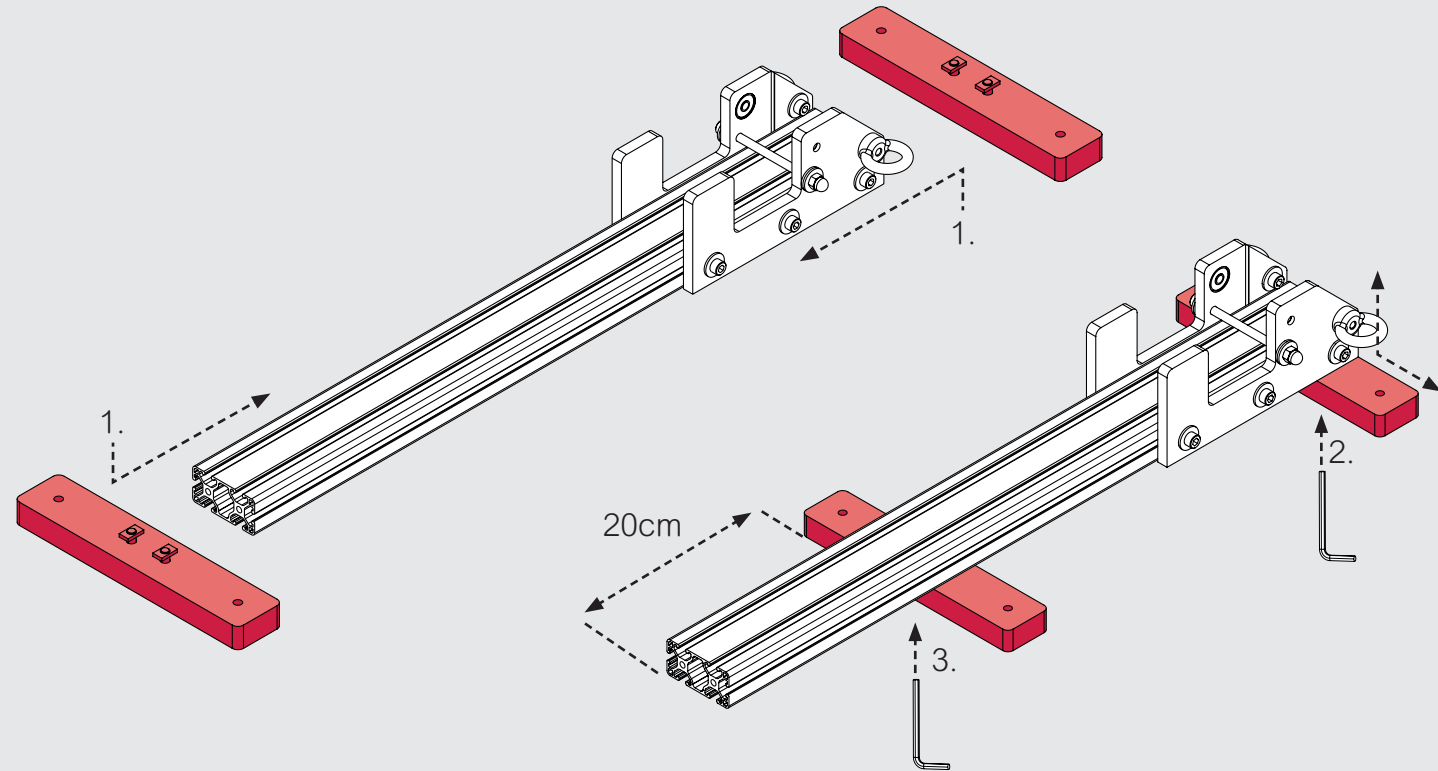

x1



M6



x1

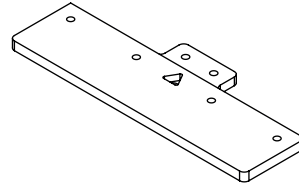

## STEP #08

1. Simply place the M6 nut  
inside the triangular pocket

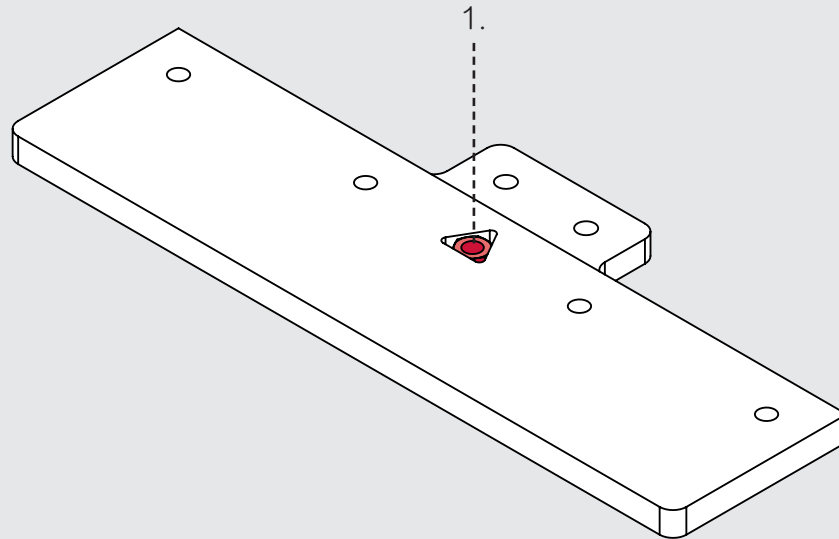

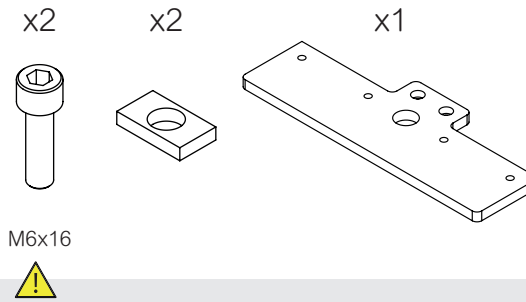

## STEP #09

1. Place the specific part underneath the other one
2. Place the two screws in the holes
3. Screw the two rectangular nuts but do not tight them (you will slide them again).

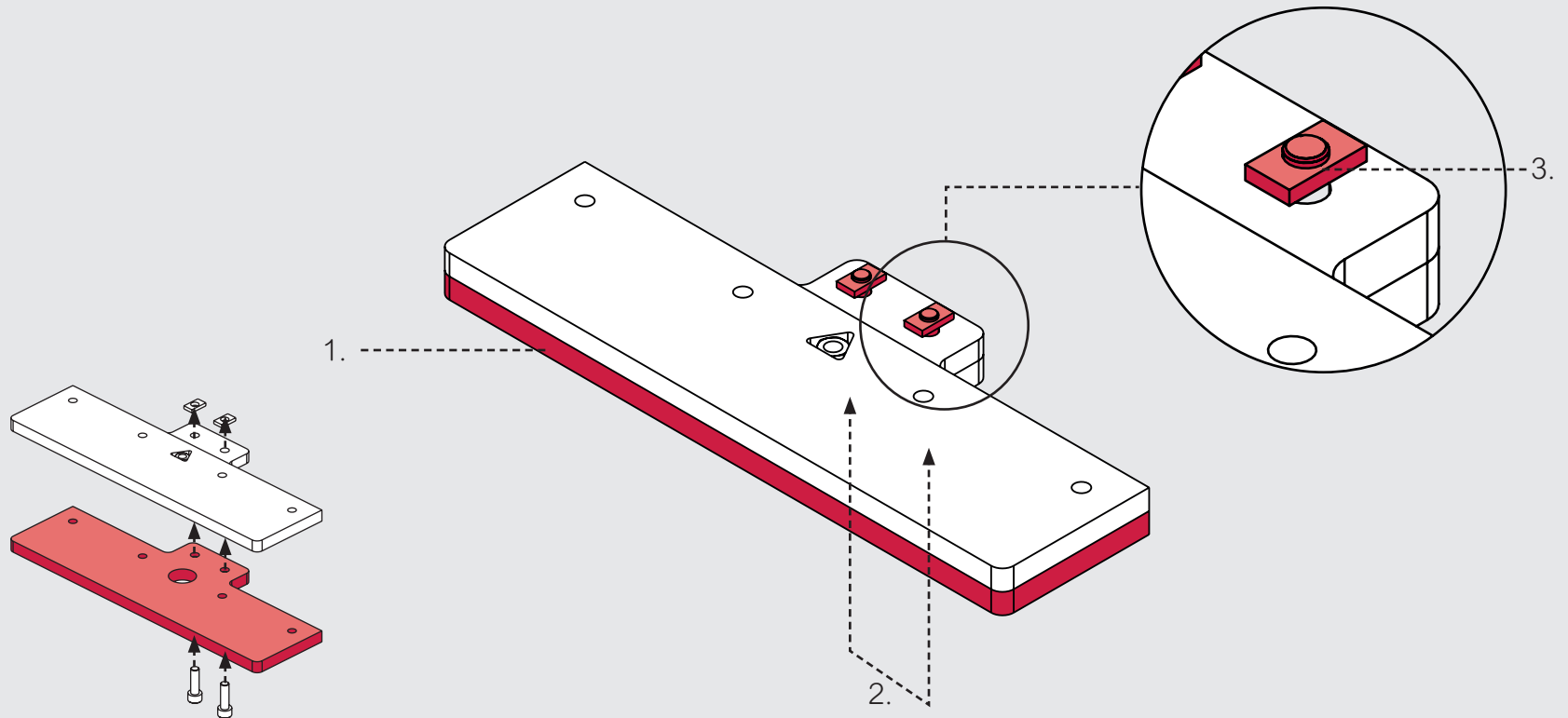

## Screen printing press ARM



5mm

x1

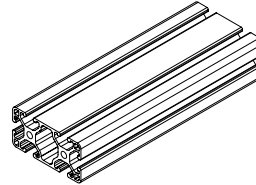

30x60x160

STEP #09

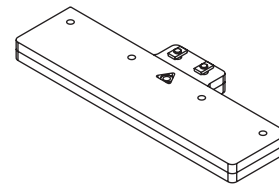

## STEP #10

1. Slide the aluminium rail as shown
2. Tight the two screws

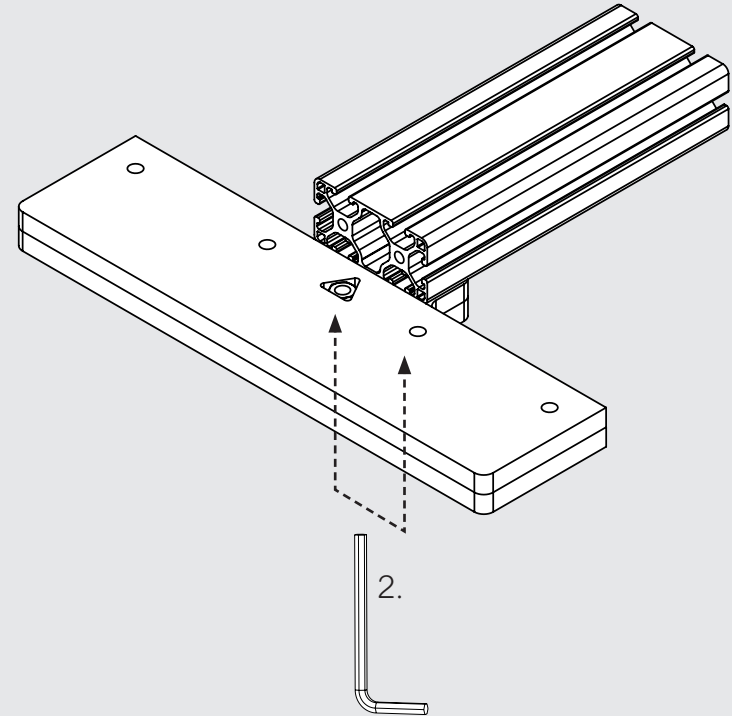
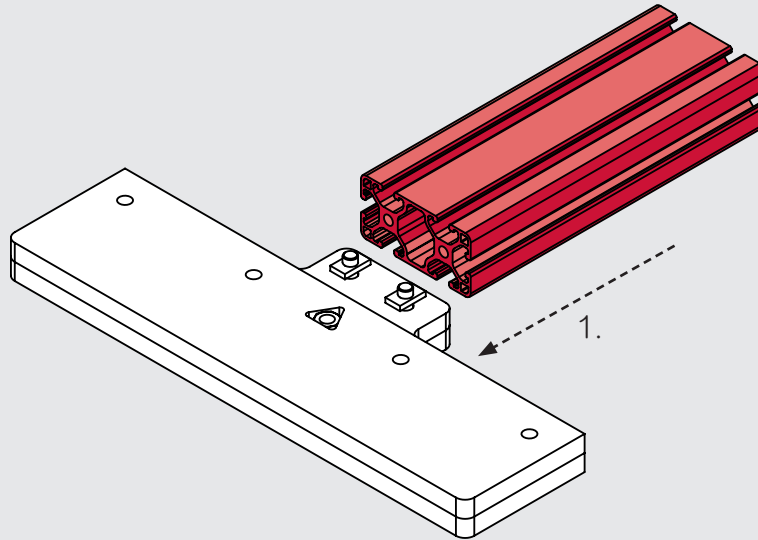

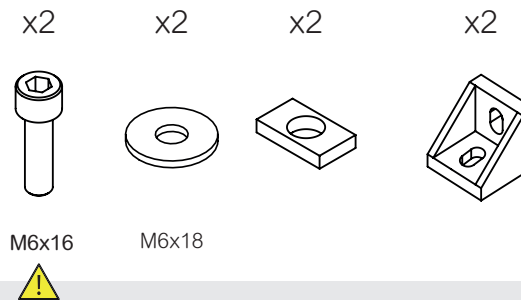

## STEP #11

1. Place the screws and washers inside the angle brackets holes
2. Screw the rectangular nuts but do not tight them. (sliding move again)

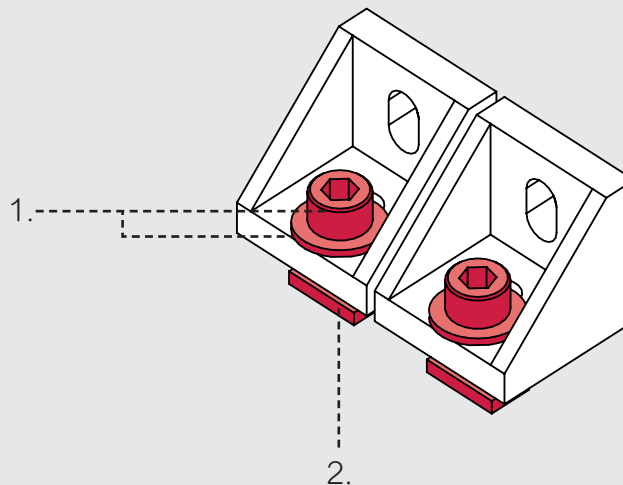

## Screen printing press ARM



5mm

### STEP #10

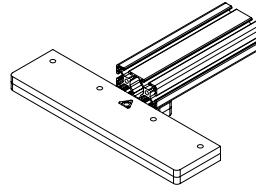

### STEP #11

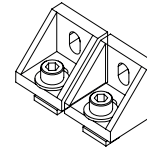

## STEP #12

1. Slide the two angle brackets with their screws into the aluminium rails
2. Tighten the two screws once the faces of the angle bracket are aligned with the face of the rail
3. Make sure the screws are tightened at the border of the angle brackets

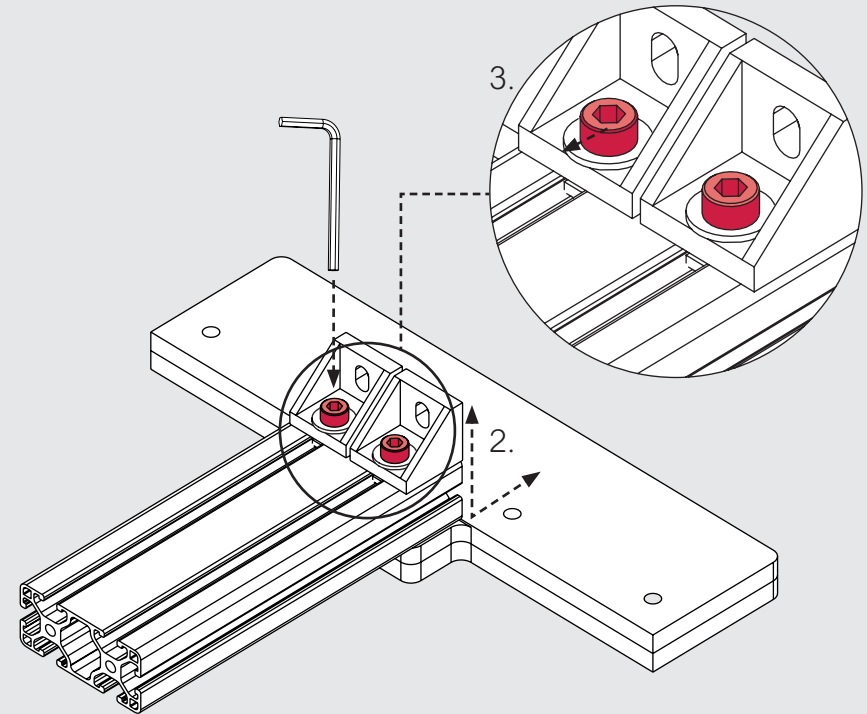
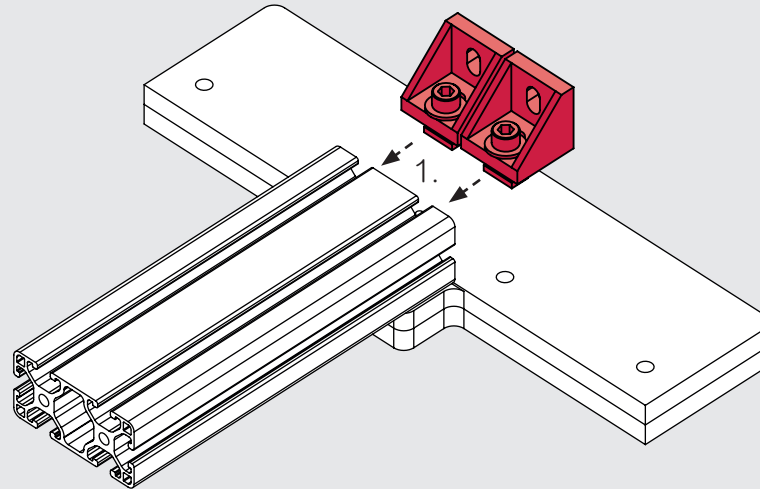



## Screen printing press ARM



5mm

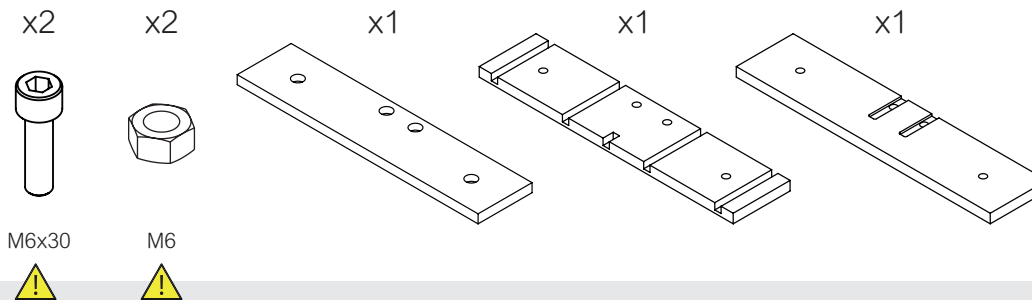

### STEP #13

1. Place the three parts in the right position
2. Place the screws
3. Tight the nuts

\*Use the 5mm Hex key to tight the screw and the multi tool to hold the nut

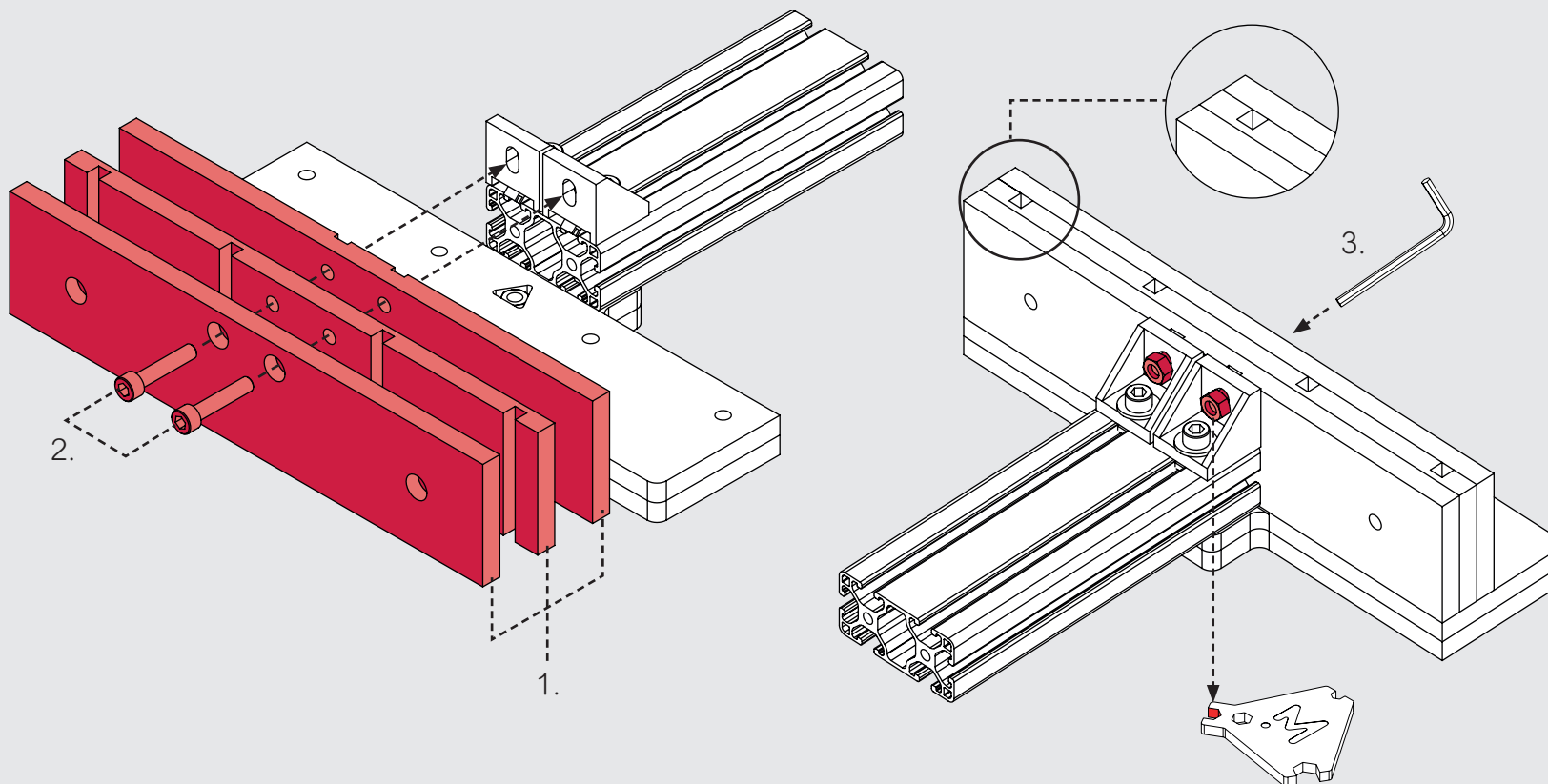

x2

x1

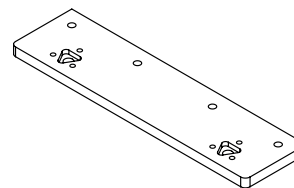

M8



## STEP #14

1. Place the two M8 nuts as shown

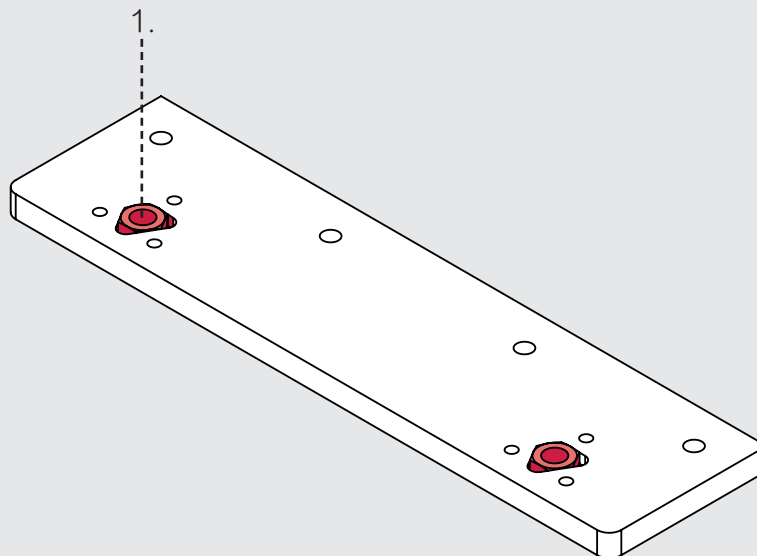

## Screen printing press ARM

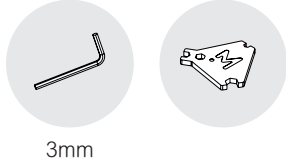

x6



M4x25



x6



M4



x12



M4x13

x1

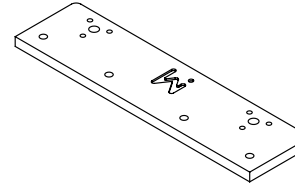

## STEP #15

1. Place the "M part" over the previous one
2. Place the six M4 screws and washers in the holes
3. Place the six washers left underneath
4. Tighten the nuts with the 3mm Hex key and the multitool

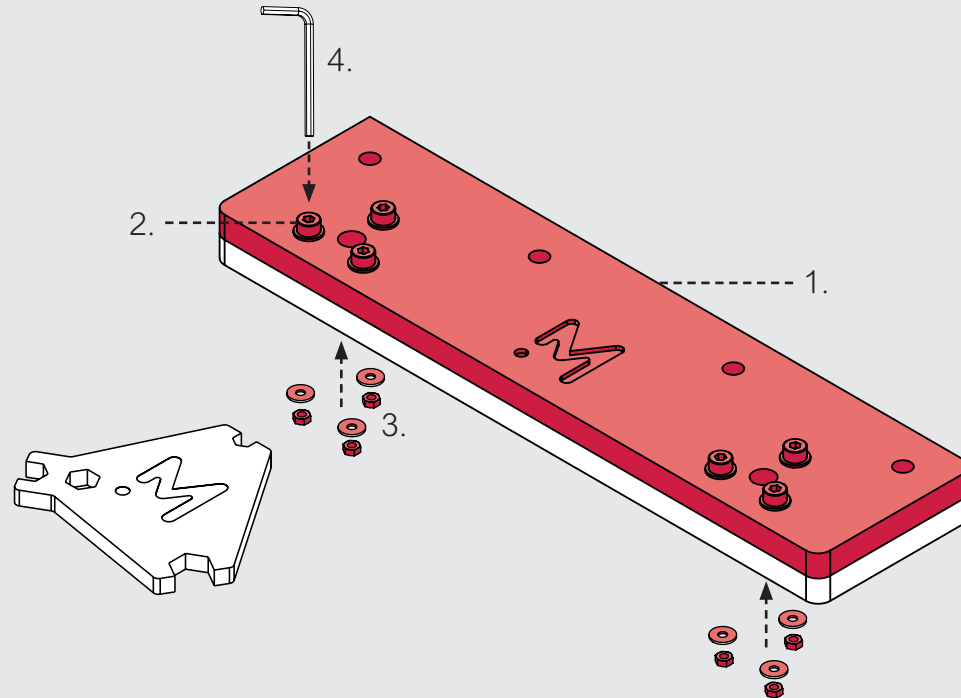

## Screen printing press ARM

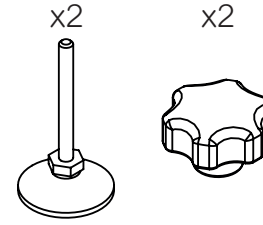

M

### STEP #16

1. Screw the two feet in the M8 nuts
2. Screw the handle manually
3. Tighten the handles firmly, hold the handle with one hand and screw the bolt with the multitool

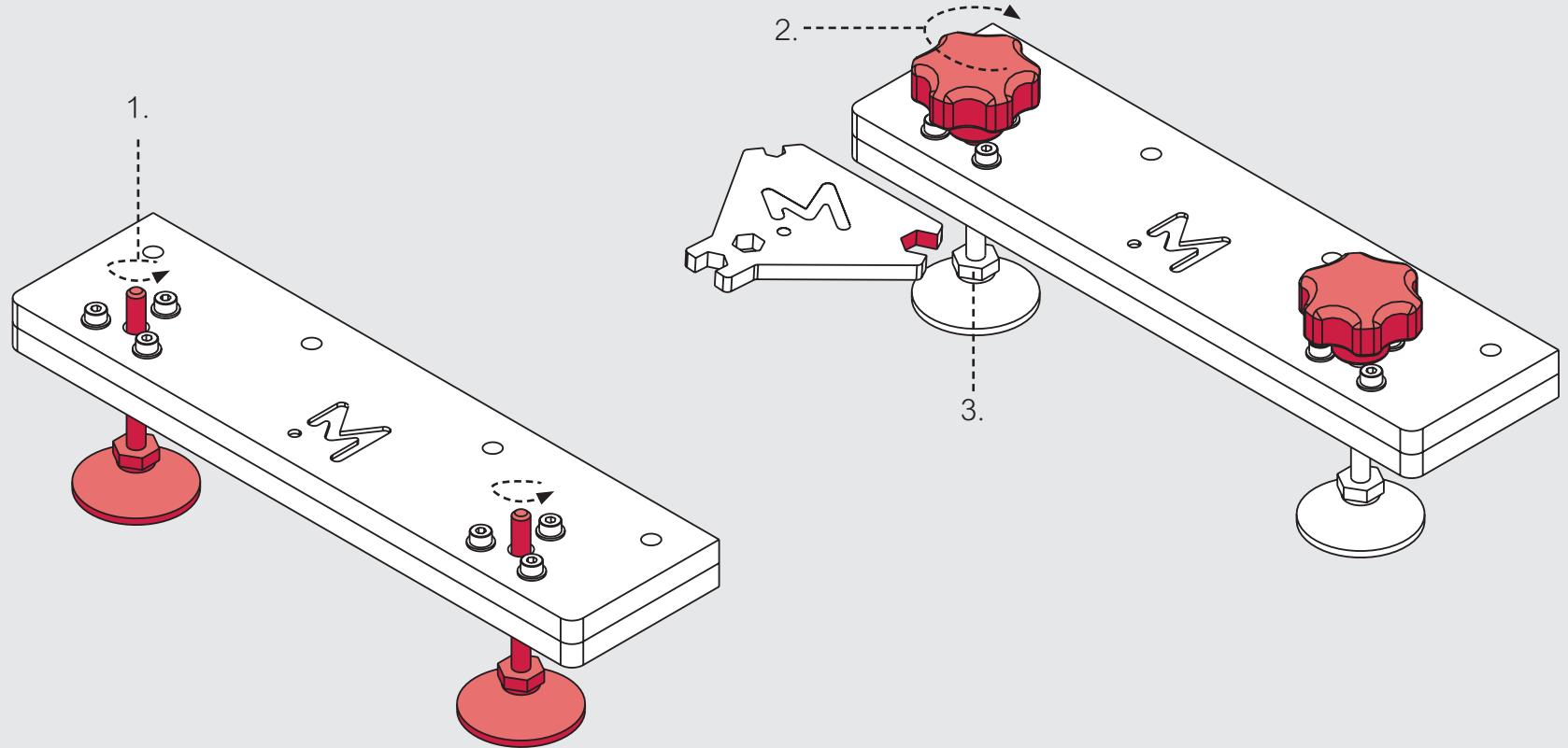

## Screen printing press ARM



5mm

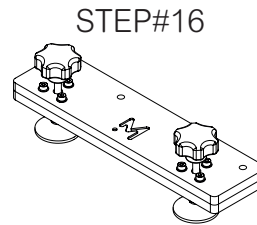

x4



M6x100

x4



M6x30



## STEP #17

1. Place the assembled STEP#16 over the premounted STEP#13
2. Place the four M6x100 screws in the holes. Do not forget the washers

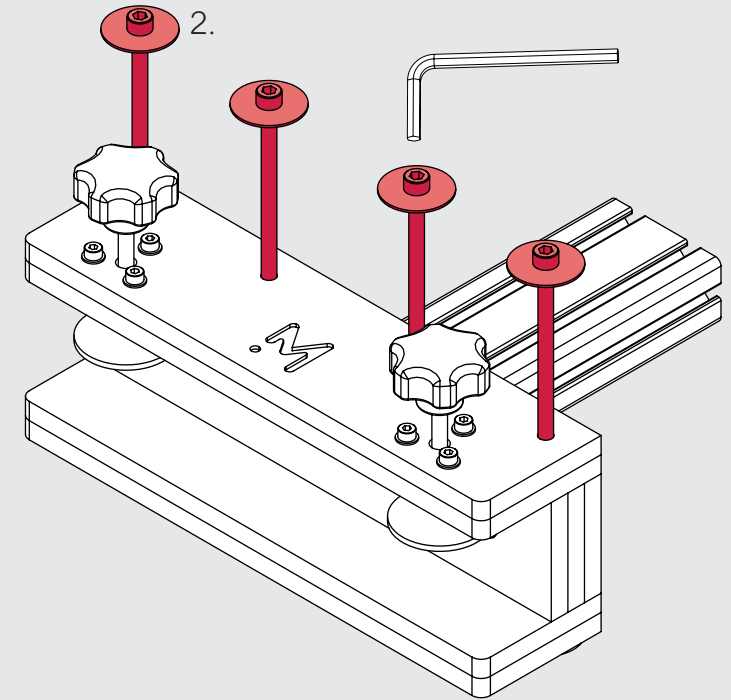
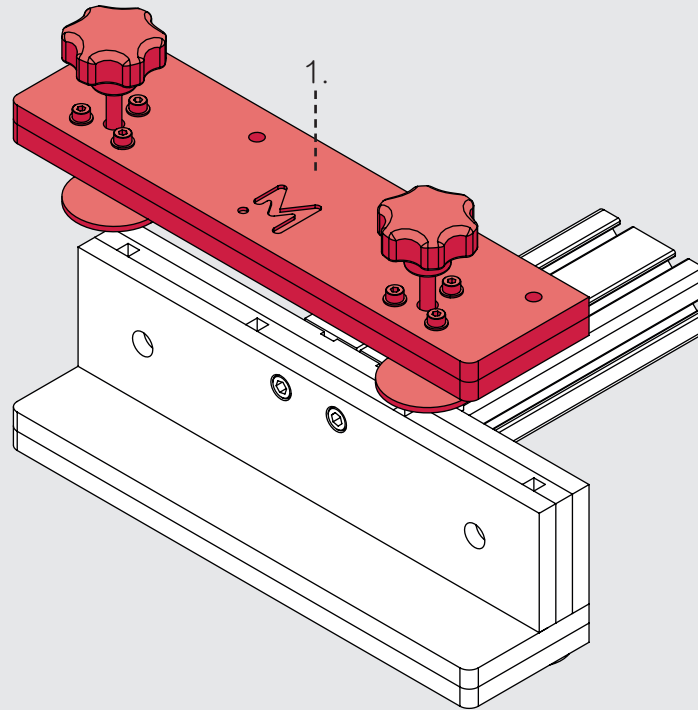

## Screen printing press ARM

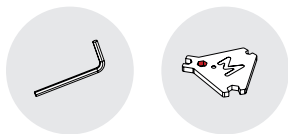

5mm

x4



M6x30

x4



x1



M6x20



## STEP #18

1. Put the STEP#17 upside down, place the washers and tight the four cap nuts left.
2. Manually screw the off-contact screw

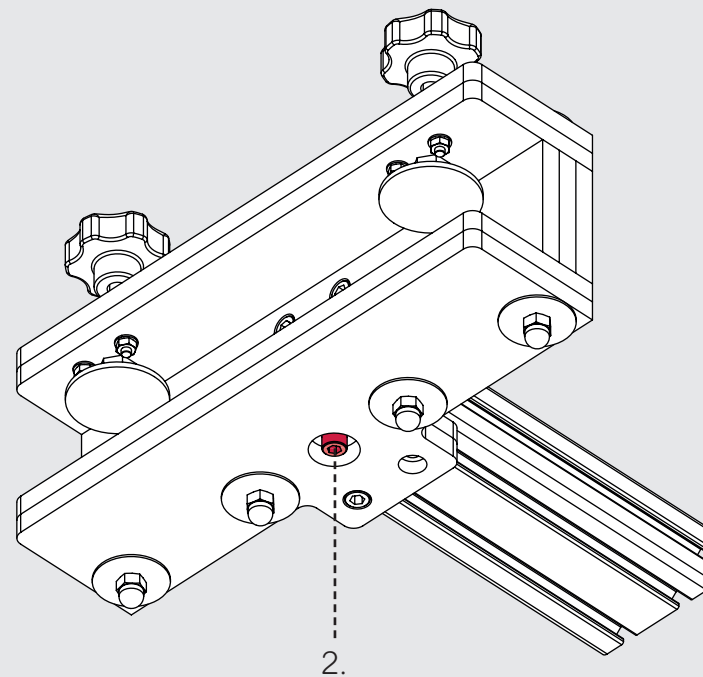
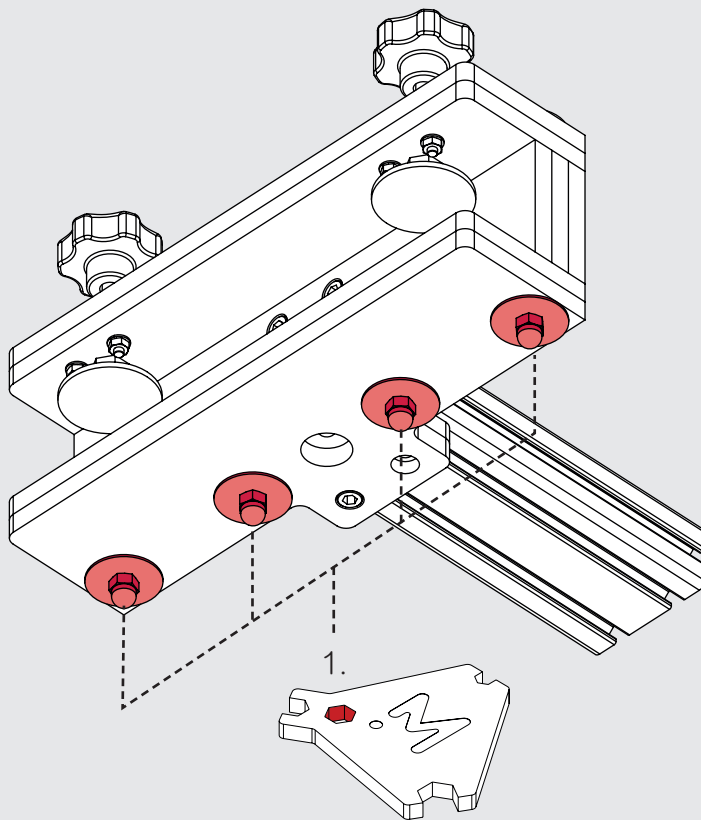

x4



M6x25



x4

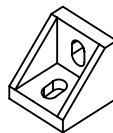

x4

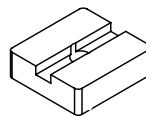

x4

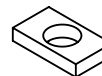

## STEP #19

1. Prepare the four angle brackets left as shown
2. Screw the rectangular nuts but do not tight them (we are sure you got it by now, you will slide them)

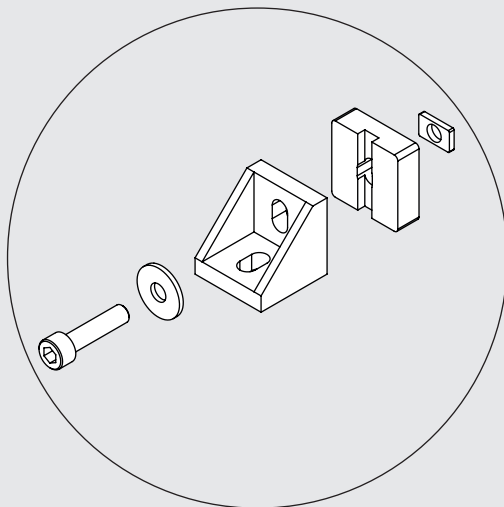

1.

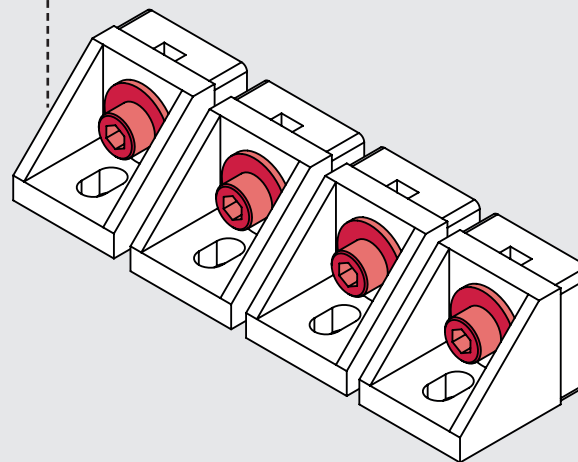

## Screen printing press PRINTING SURFACE

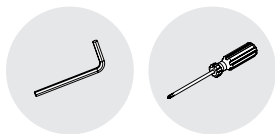

5mm

x4

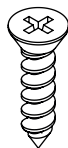

4,5x25



x4



M6x18

STEP#19

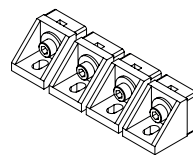

x1

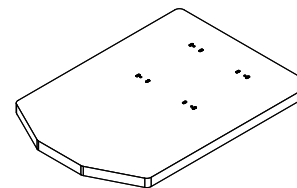

M

## STEP #20

1. Place the four prepared angle brackets in the slots
2. Place four 4,5x25 wooden screws with **washers** and screw them

\*You need a cross-head screwdriver

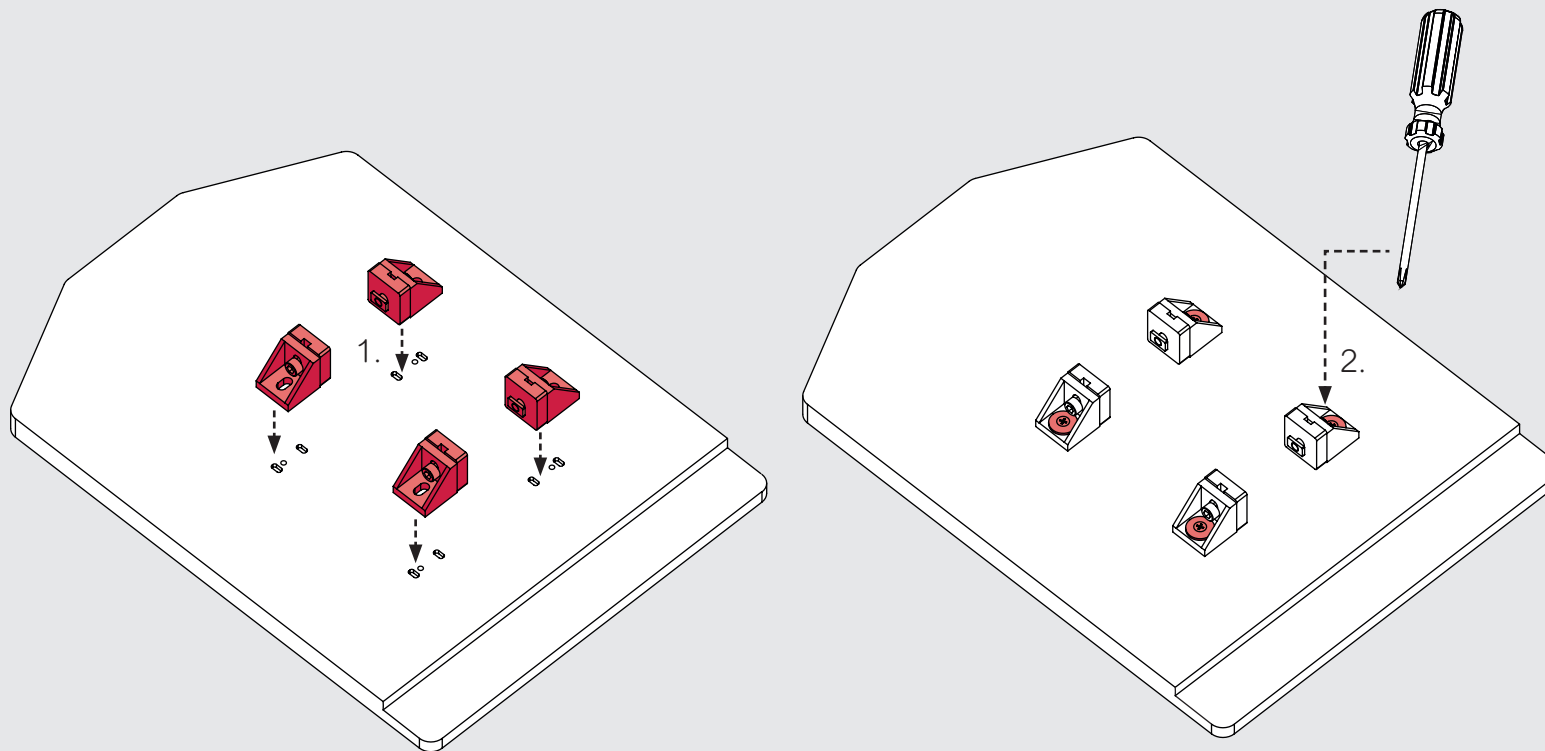



## Screen printing press FINAL ASSEMBLY

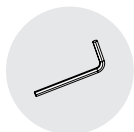

5mm

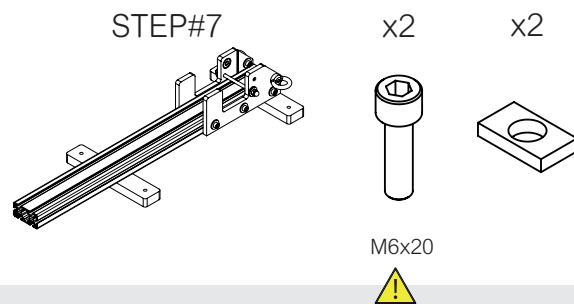

## STEP #21

1. Place the two screws inside the last spare holes of the first part. (where you inserted the bearing at #STEP01)
2. Screw the rectangular nuts but do not tight them.

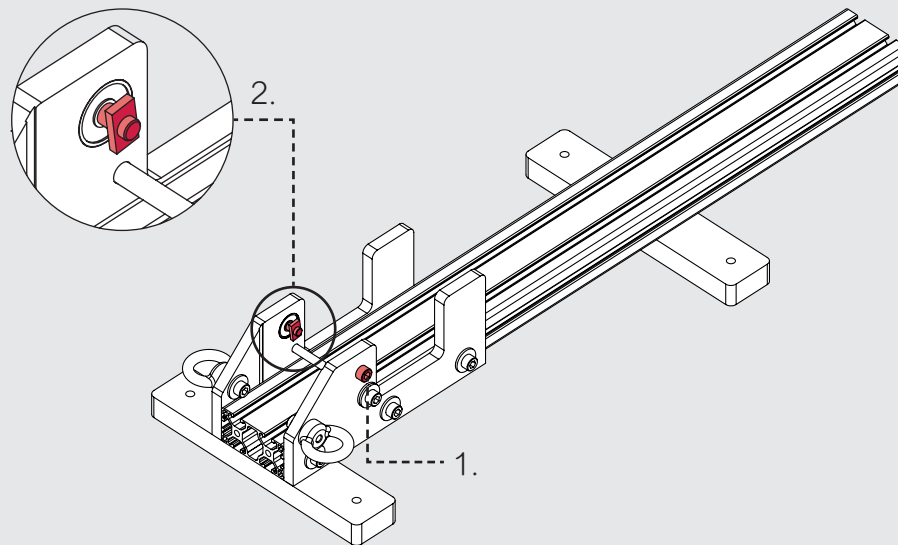

## Screen printing press FINAL ASSEMBLY



5mm

STEP#21

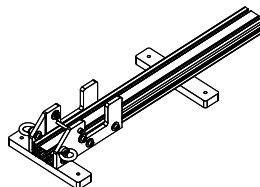

STEP#18

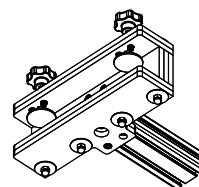

## STEP #22

1. The idea of this step is to slide the **ARM** you built up few minutes ago on the two nuts you have just mounted
2. Once the aluminium profile is aligned with the red slot, tighten the screws.  
\*There are no washers with these screws
3. Tighten now the screws you placed on STEP#4

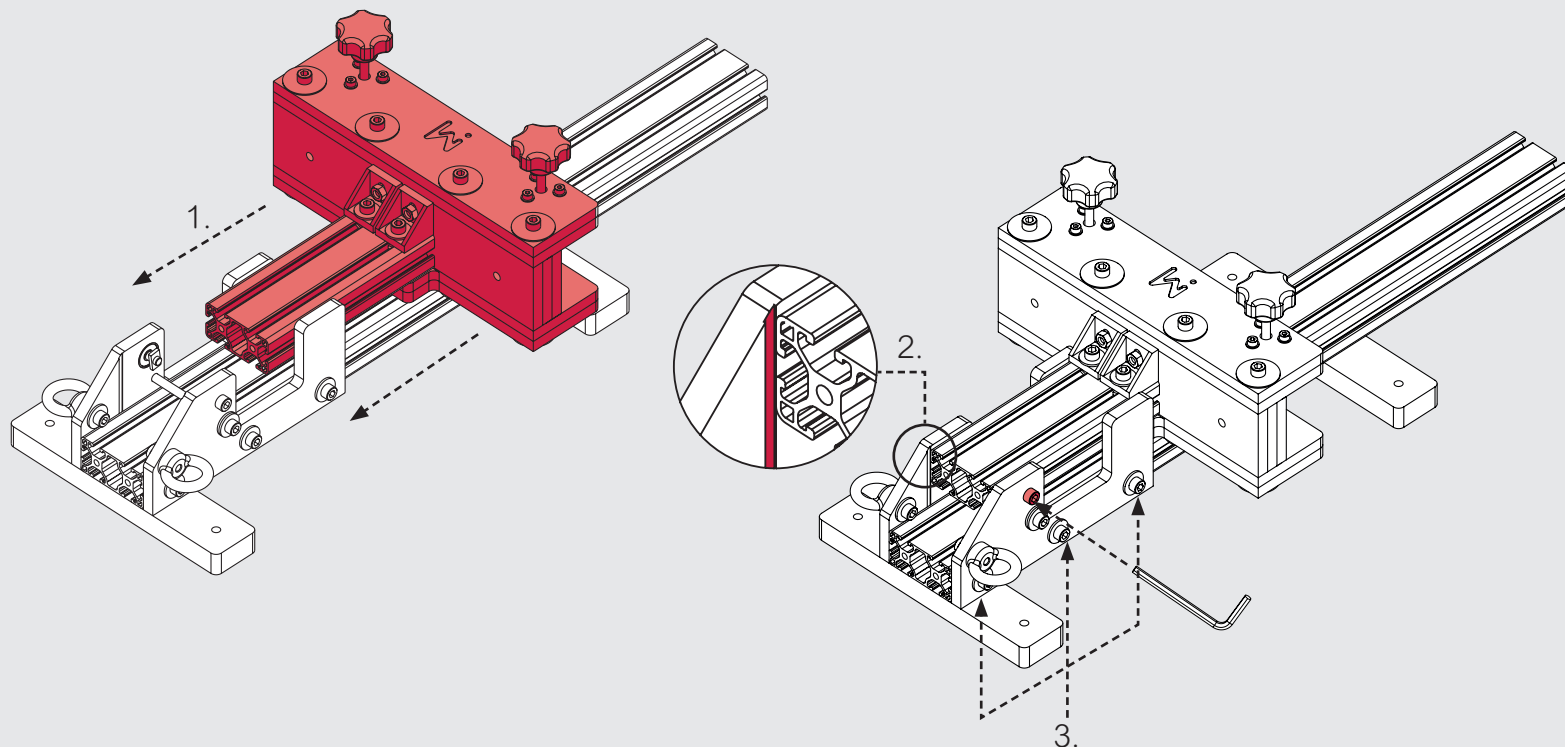

## Screen printing press FINAL ASSEMBLY



5mm

x2



M6x40



x2



x2

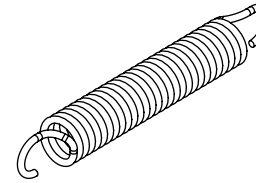

### STEP #23( the tricky one)

1. First, lift up the **ARM**
2. Attach the spring to the lower eye nuts first
3. Place the two eye nuts left on the other side of the springs
4. Place the two screws in the holes
5. You should now be able to reach the thread of the eye nuts with the screws, in this case, fully tighten them.

\*If you can not reach the eye nuts with the screws :

- make sure the **ARM** is still up
- make sure you are using the M6x40 screws
- make sure that on STEP#22, the aluminium profile is aligned with the slots
- Try to pull on the spring
- Throw all the machine away^^

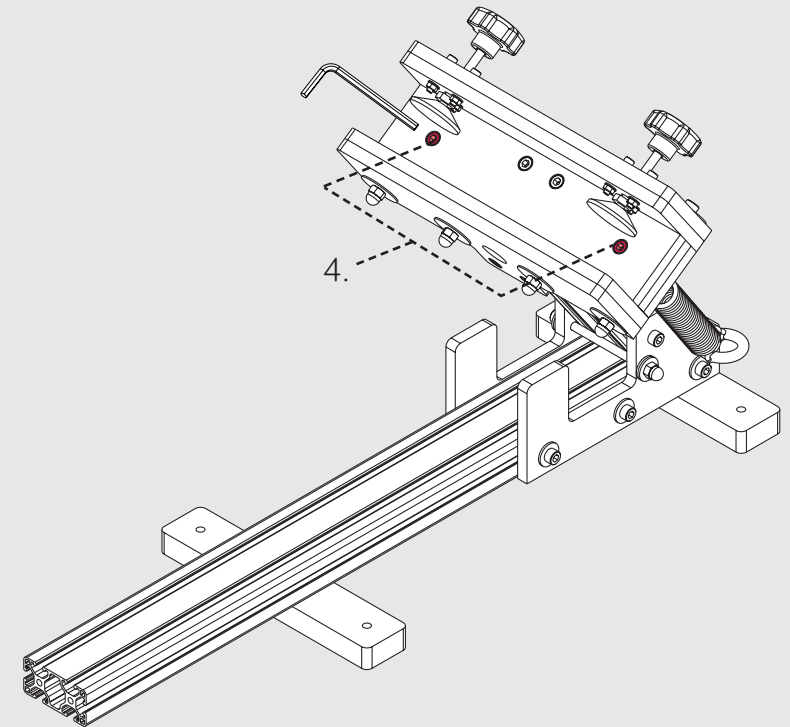
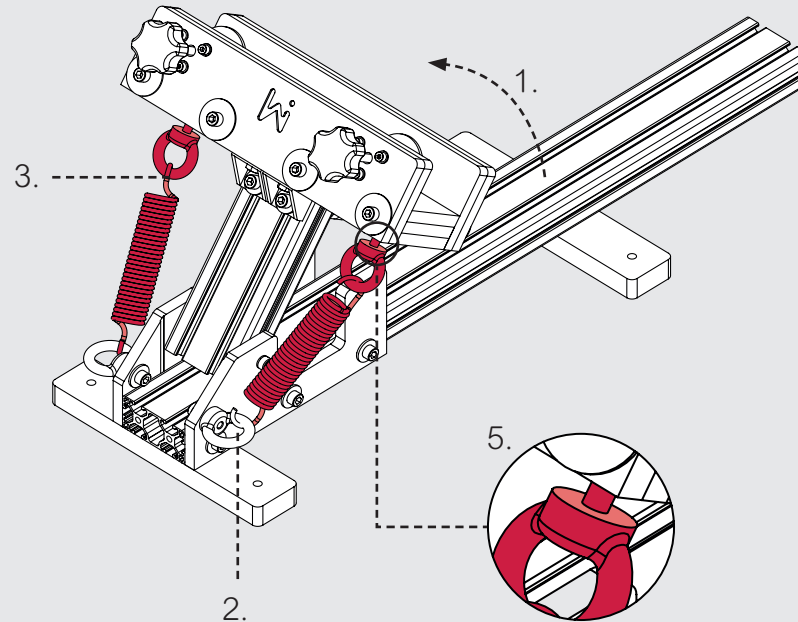

## Screen printing press FINAL ASSEMBLY



STEP#23

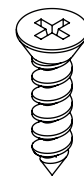

4,5x40

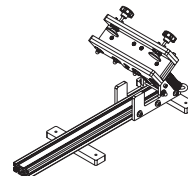

## STEP #24

Before mounting the printing table, we recommend you to fix your screen printing press to your working area.

1. You can either fix it with the included wooden screws or either clamp it with your own tools.

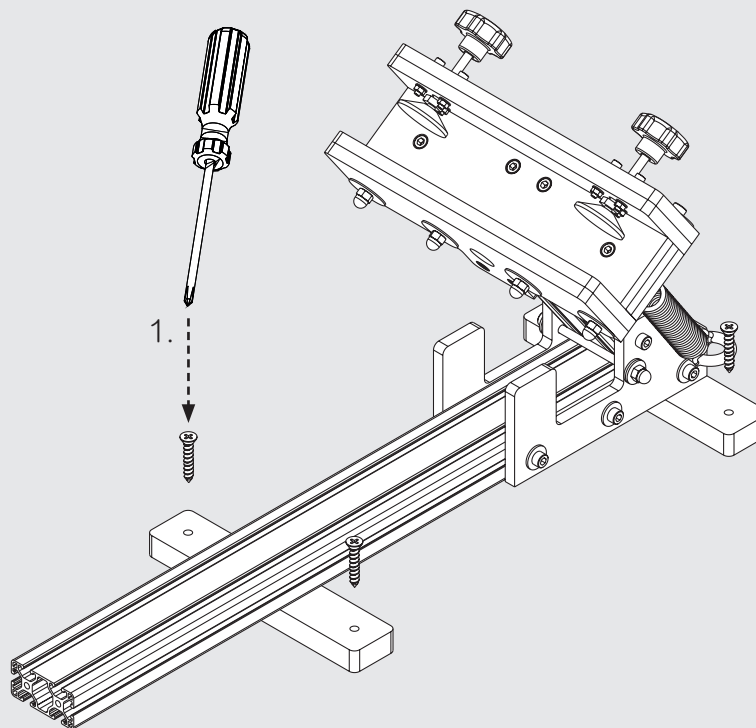

## Screen printing press FINAL ASSEMBLY



5mm

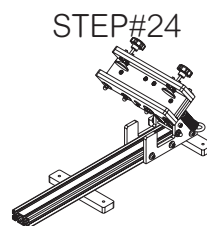

### STEP #25

1. Slide the pre-mounted printing table (STEP#20) on the aluminium rail
2. Tighten the screws once the table is 5mm away from the front of the **ARM**

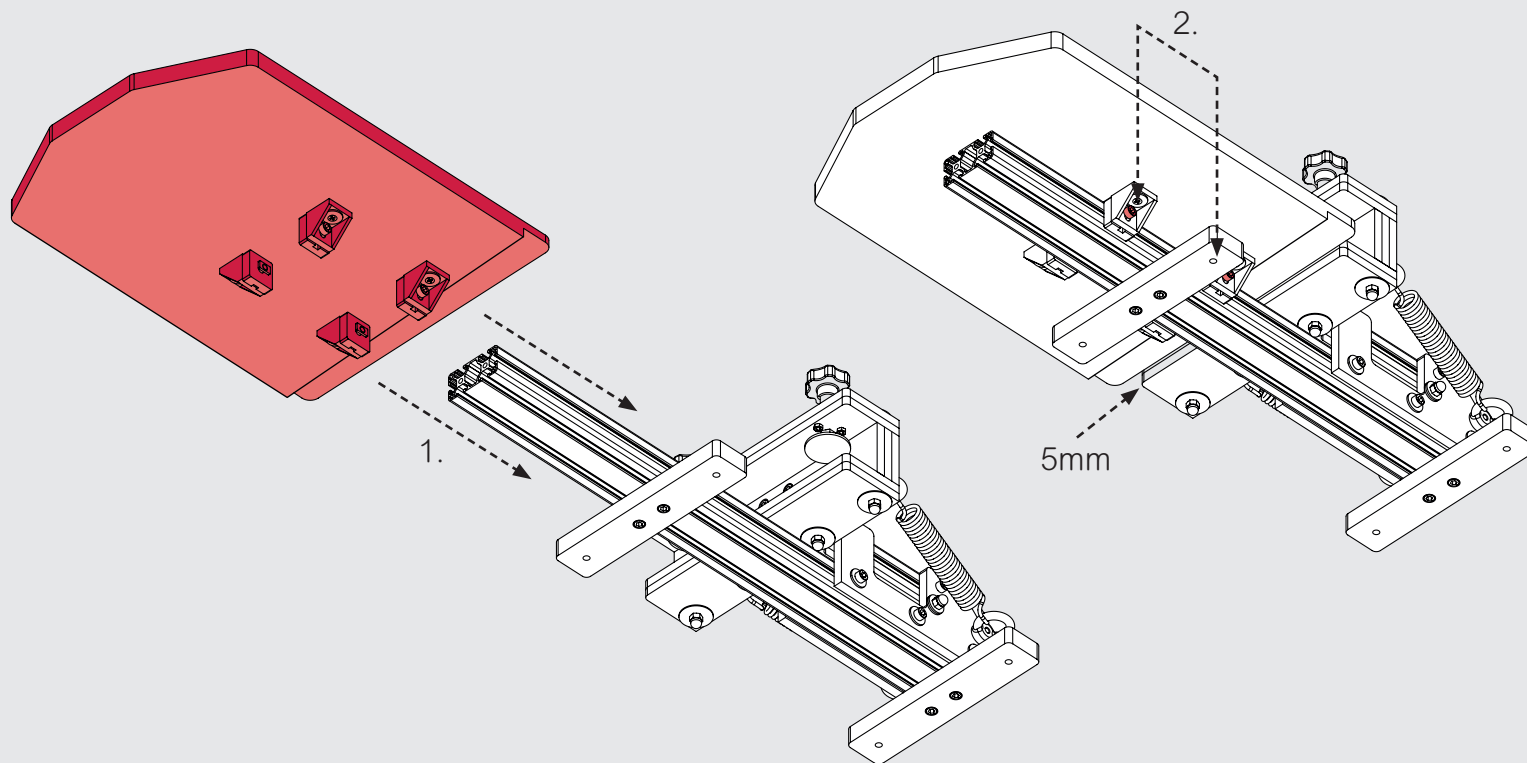

## CONGRATULATIONS!

Good job! Your screen printing press is now ready to print dozens of T-shirts and tote bags. Do not hesitate to share the results of your prints on the social media and tag @mekanika.io

\*Before your first print, check all the screws and tight them a bit more than usual. it will make your press stronger and more rigid.

